

32"
MAX

2.2-20lbs
RATED

Human Active Technology
800 524 2744
customerservice@team-hat.com
team-hat.com

PARTS LIST

A Top Down Mount 1x
8524

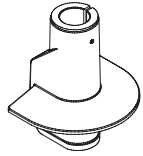

B Quick Connect VESA Plate 1x
114808

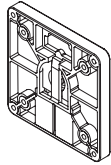

C M4 x 12mm Phillips Pan Head Screw 4x
701153

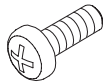

D 3/32" Allen Wrench 1x
700146



E 6mm Allen Wrench 1x
717654

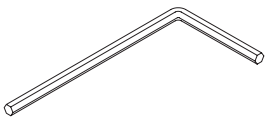

F 4mm Allen Wrench 1x
709877

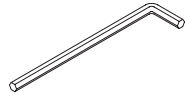

G 5mm Allen Wrench 1x
710838

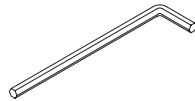

H* M8-1.25 X 100mm L SHCS 1x
712262

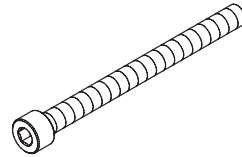

I* Spacer 1x
701544

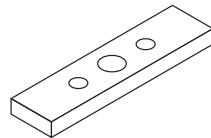

J* Lock Nut 1x
710015



DESK CLAMP CONFIGURATION

1

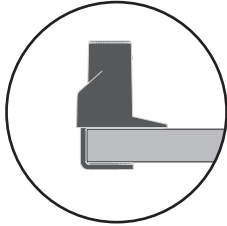

Desk thickness
up to 1.5" (3.8 cm)

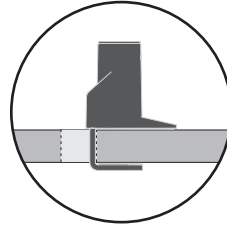

Desk thickness
up to 1.5" (3.8 cm)

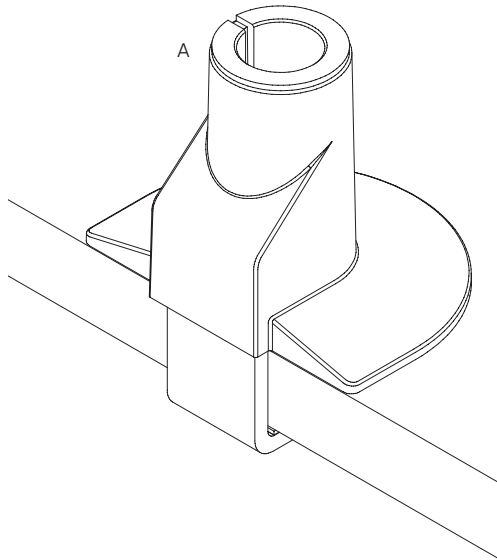

OR

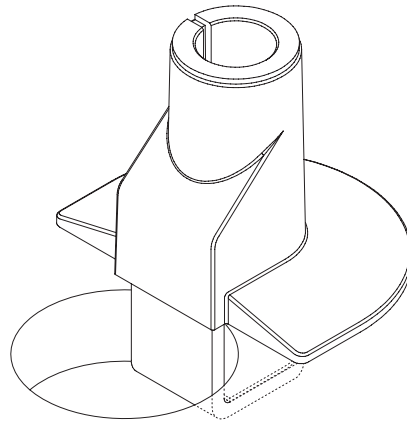

2

6mm
Tighten to
60 in-lbs
minimum

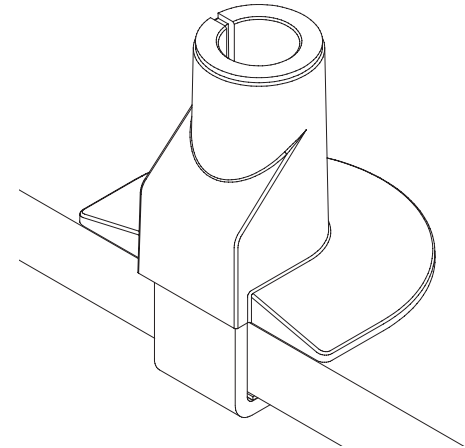
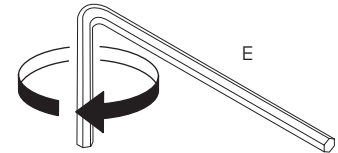

i If the monitor arm or pole does not easily fit into the mount, remove the bushing from the mount and place it on the monitor arm or pole and press firmly back into the mount.

2a

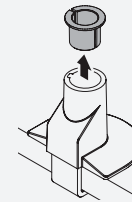

2b

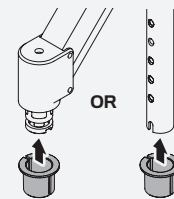

2c

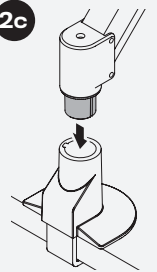

THRU-DESK CONFIGURATION*

3

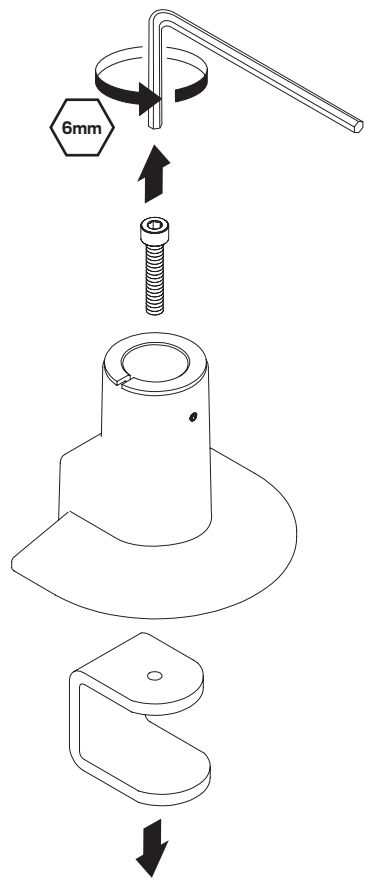

4

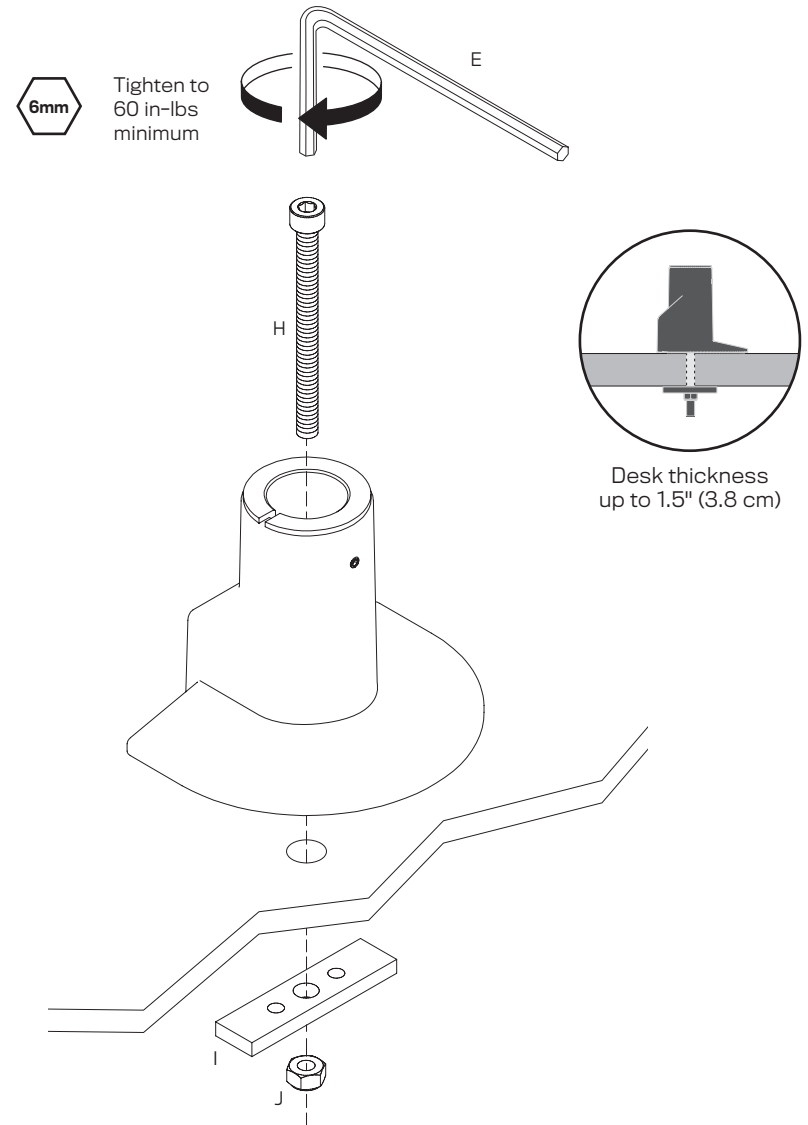

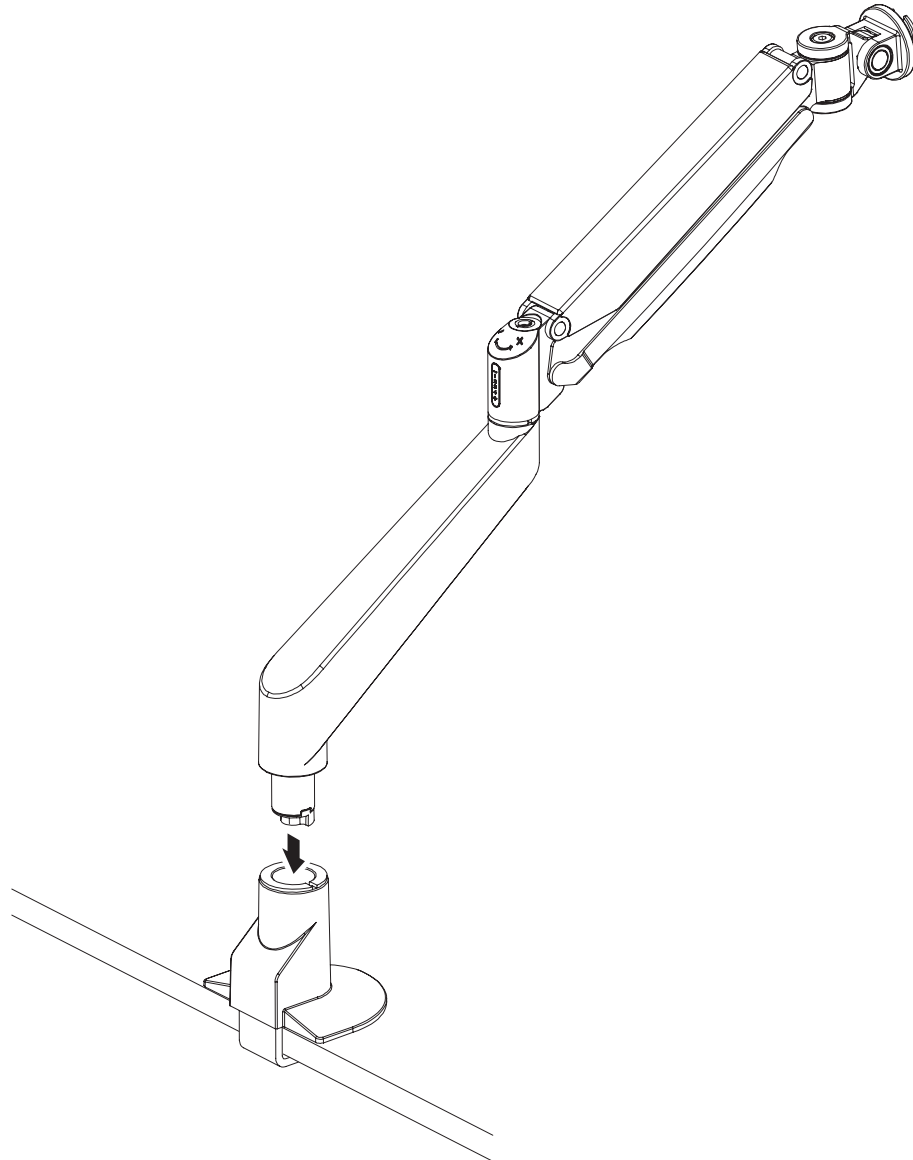

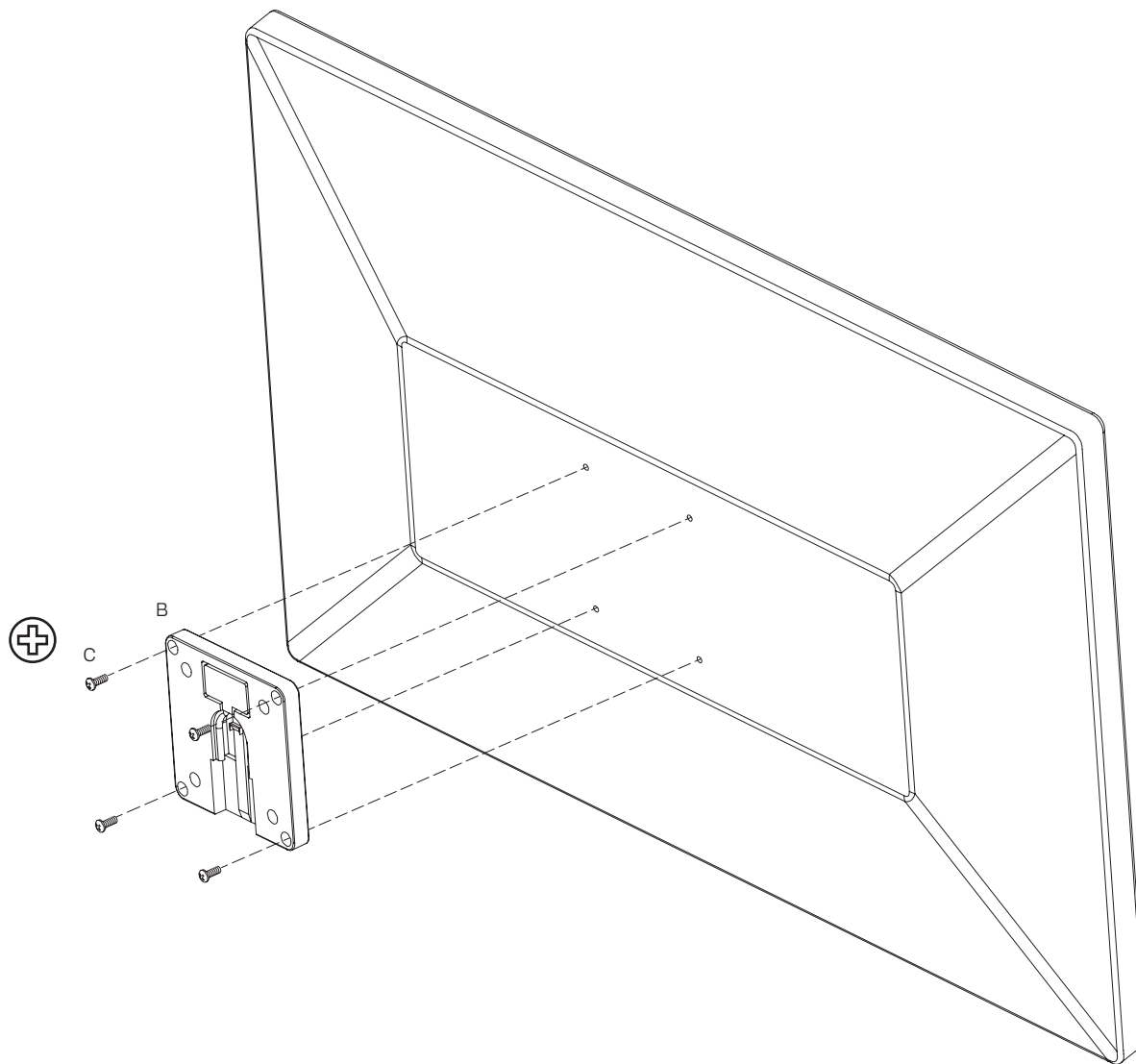

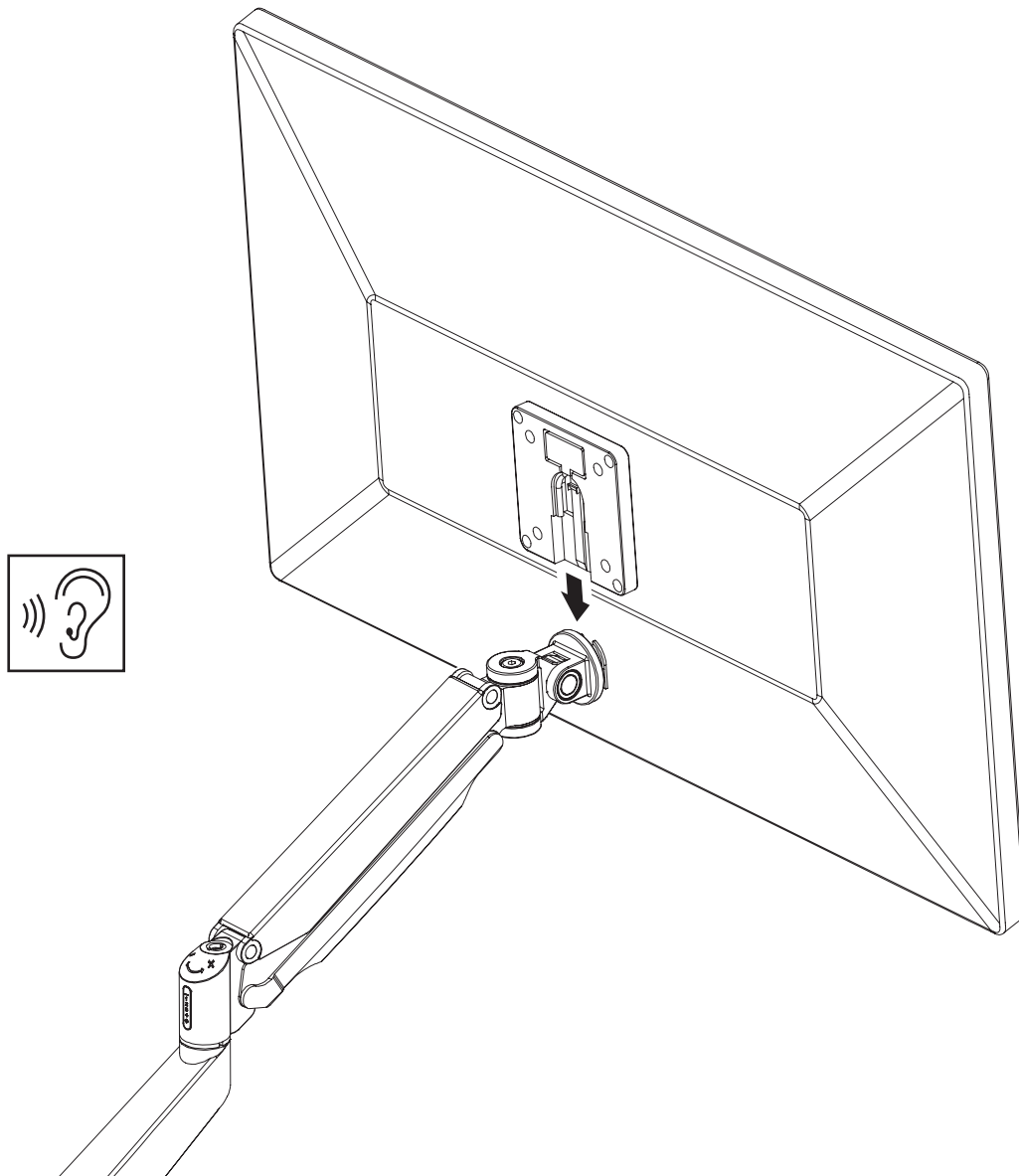

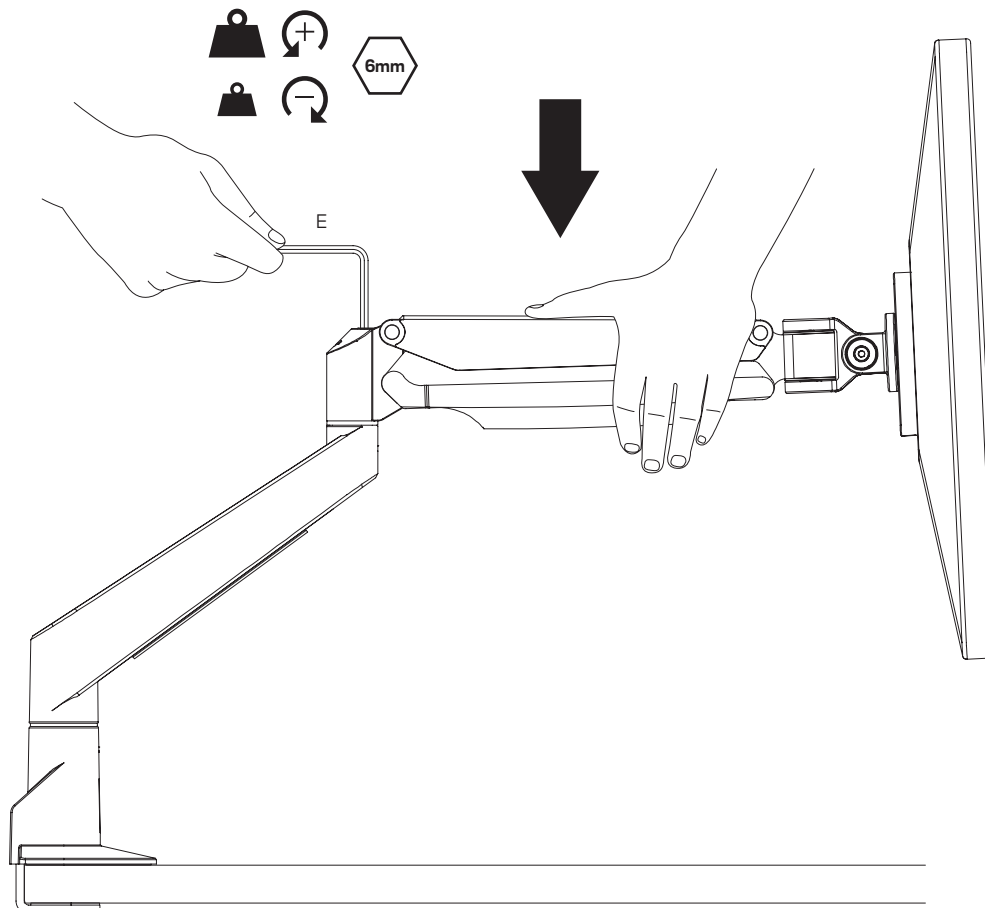
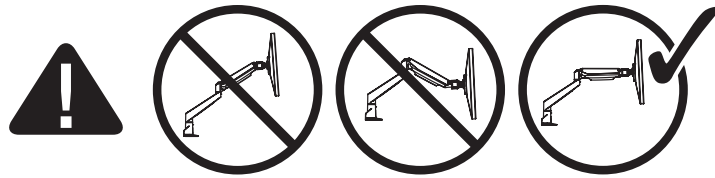

i TENSION INDICATOR

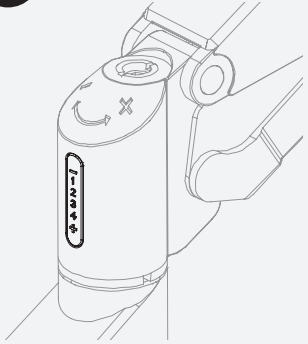

The tension indicator can be used to quickly set multiple arms that will be utilizing the same monitor weight to the correct tension.

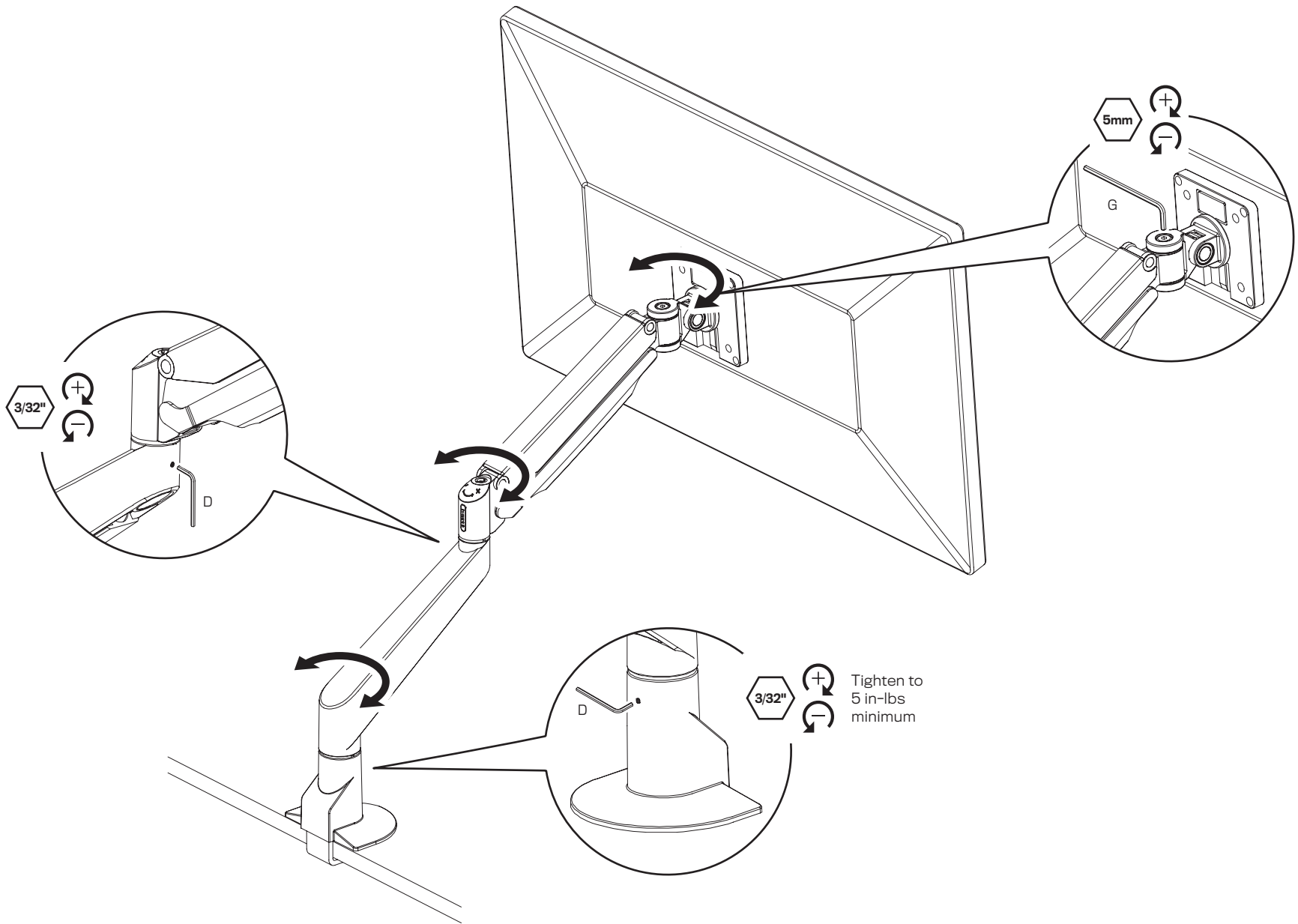

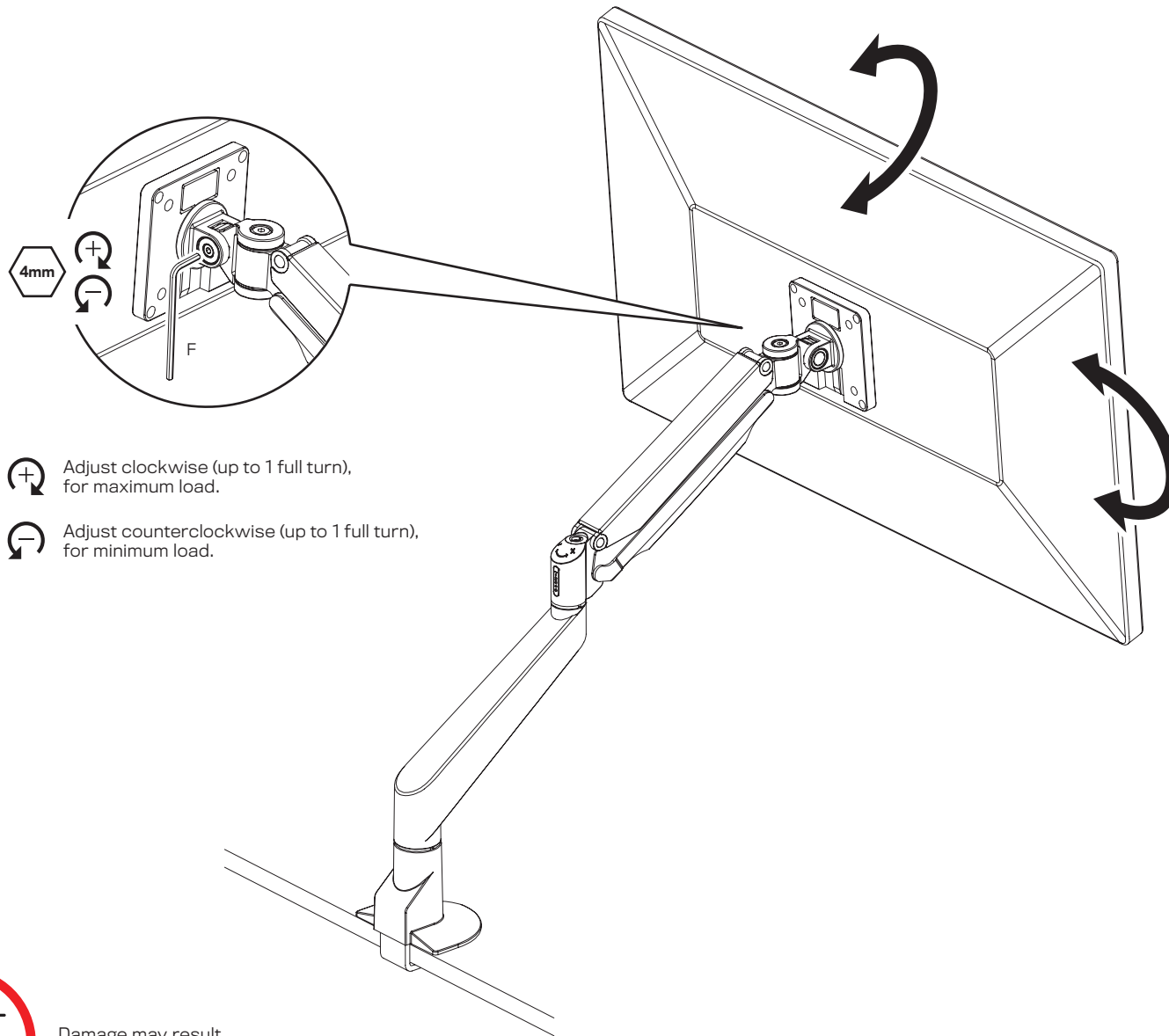

Damage may result,
due to overtightening.

